

Maintenance instructions

Maintenance of front doors	2
Post-adjustment of frame, hinge and striking plate	3
Lubrication of hinges and locks	5
Handling/sorting – residual waste from the door	6

Maintenance of front doors

For your front door to withstand the elements year after year, it needs a little maintenance every now and then. In this document, you can read about how to best take care of your door. The maintenance must be done regularly and doesn't take long.

Painted front doors

Painted front doors also need maintenance. At least every two months, wash the door with lukewarm water (no soap) or with dish soap diluted in water. This applies to both the surface of the door and mounted door fittings (e.g. hinges and doorbell). It is important to avoid strong detergents that contain e.g. ammonia or solvents.

Treat the door during assembly, then at least two times a year with liquid hard wax, i.e. car or furniture wax, alternatively with a wax cloth. The wax must not contain abrasives or silicone. Dark colors tend to fade from sun, salt, and rain. To increase the lifespan, the door should be placed under an entrance roof. This is especially important if there is no overhang. Paint damage must be repaired immediately with Alkyd paint for outdoor use in the correct shade and gloss. Otherwise, the guarantees do not apply.

Wax your painted front door

- Remove dirt (e.g. sand and gravel) with a damp cloth.
- Wax the clean surface thoroughly.
- Allow the surface to dry for 30 minutes and, if necessary, polish the surface with a soft, lint-free cloth.

Note! Never wax the door when it is hot or in direct sunlight.

Threshold

The threshold is untreated and must be oiled with wood oil before assembly, and continuously as needed.

Post-adjustment of frame, hinge and striking plate

Is it difficult to open and close the door? Is there a gap between the door and the frame? In this section, you'll get tips on how to solve these problems.

Frame adjustment

Incorrect installation is a common reason why the door does not work as intended. In addition, the house and subsidence move over time, which means that a previously straight frame can get skewed.

Important! Keep in mind that a 2 mm deviation at one end can be a couple of cm in the other end. Therefore, be sure to check that the frame is aligned horizontally and not out of plumb. The pre-assembled frame sleeves allow readjustment so that the frame can be straightened again. Follow the instruction below.

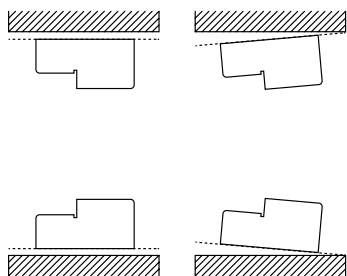

Check that the frame is not twisted.

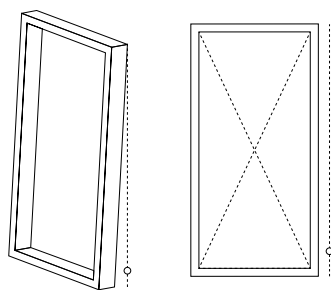

Check that the frame does not lean outwards or inwards, cross-measure carefully.

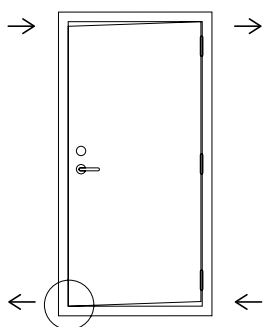

The front part of the door leaf is rubbing at the bottom of the frame.

Adjust the frame according to the arrows using the frame sleeves.

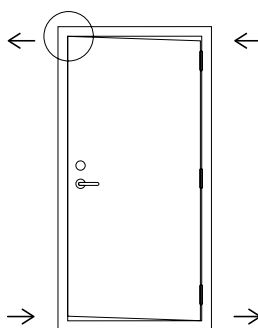

The upper part of the door leaf is rubbing at the top of the frame.

Adjust the frame according to the arrows using the frame sleeves.

Adjustment of hinges

When you have checked that the frame is correctly mounted and adjusted, further adjustment may be needed for the hinges.

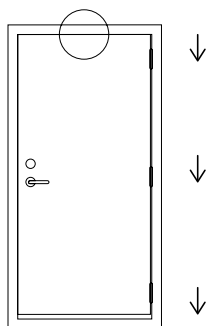

The entire part of the door leaf is rubbing at the top of the frame.

Adjust the door leaf according to the arrows using the hinges.

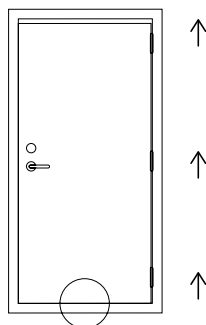

The entire part of the door leaf is rubbing at the bottom of the frame.

Adjust the door leaf according to the arrows using the hinges.

When adjusting the height of the hinge, unscrew the hinge cover and adjust using a hex key. The door leaf moves up when moving clockwise and down when turning counterclockwise. Make sure all hinges are equally adjusted.

Make sure that the gap between the frame and door is even all around. The gap should be 2-3 mm around the entire door leaf or between the door leaves in a double door.

Tip! The hinges can also be set sideways. Lightly loosen the hinge screws on the frame, then adjust laterally by unscrewing the torx screws. Tighten the hinge screws after completing the adjustment.

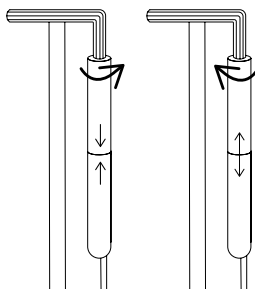

Adjustment of striking plate

To adjust the closing pressure and make the door leaf align with the frame, you may need to adjust the striking plate. The inner part of the plate is movable and can be adjusted in depth by loosening the two adjustment screws.

If the door is hard to close, the inner part of the striking plate may need to be pushed outwards. If you experience that the door is outside the frame or that it fits loosely, it can be pushed inwards. Tighten the adjustment screws to the desired position.

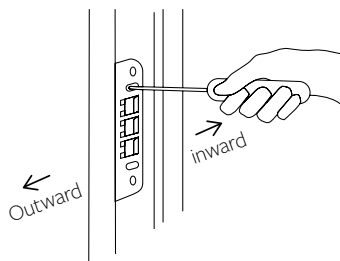

Lubrication of hinges and locks

The hinges must be lubricated for the first time before the door is put into use, and thereafter if necessary.

Lubrication of hinges:

1. Loosen the hinge cover and apply lubricant intended for pin-bearing hinges directly to the hex screw.
2. Put the hinge cover back on.

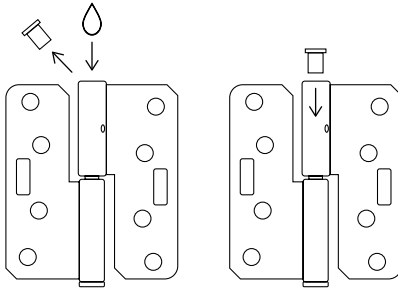

Lock spray is a lubricant that significantly increases the functional reliability and service life of the lock cylinder. It is ready to use after a light shake. Lubricating grease is used to lubricate the lock's drop and control pistons to prevent them from building up resistance and secure a smooth experience.

Lubrication of the lock and cylinder should take place approx. 1-2 times/year.

Lubrication of locks:

1. The plastic tube is inserted into the keyhole on the lock cylinder, after which the spray button is pressed for approx. 1 second.
2. Insert the key and turn it a few times.
3. Wipe the key.
4. Apply lubricating grease to the lock's drop and control pistons.

ATTENTION!

Lock spray must not be used to lubricate electric lock housings or the Yale Doorman.

Handling/sorting – residual waste from the door

A door in good condition can be advantageously reused. If the product is not to be reused, disassemble according to the instructions below and leave the parts for recycling.

Instructions for disassembly:

Depending on the type of product, the parts below vary. Each respective fraction is sorted according to the local waste recipient.

1. The door leaf is unhooked from the frame.
2. Loosen any glazing strips with a chisel/knife or screwdriver to release the glass.
3. Loosen all rubber sealing strips (around the door leaves, in the frame and any glazing).
4. Remove striking plates, hinges, handles, lock housings and cylinders (fittings can often be reused or sorted as metal).
5. Unscrew the frame from the wall. Adjust frame sleeves if necessary, so the frame can be lifted out.
6. For the recycling of aluminum in the threshold, separate the wear rail from the wooden part.

The door leaf contains wood, cellular plastic and aluminum. For questions about recycling composite material, contact your local waste receiver.

